

Technical Specification

CL1S

Product Name:	CL1S
Category:	Star Light
Description:	Recessed LED Star Light with 1 x 1.2W Osram LED



Features:	Available in Natural and Warm White	Applications:	Hotels
	Non-Dimmable		Offices
	1 x 1.2W Osram LED		Shops
	Power consumption per star light = 1.9W		Restaurants
	102 Lumen Output – Natural White		Reception Counters
	Available in beam angles of 15° and 67°		Display Cabinets
	L70 > 50,000 hrs at Ta = 25° Celsius		Houses
	IES Files available on request		(Indoor use only)
Individual driver for each star light			

Dimensions

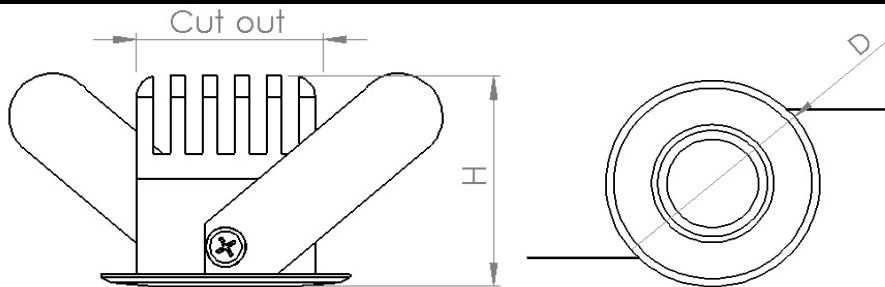

Product Code	Diameter (mm)	Height (mm)	Cut-Out Diameter (mm)
CL1S	35	30	32



Electrical Characteristics

Parameter	Value	Unit
LED Drive Current	350	mA
Operating Voltage/Frequency	220-240/50-60	V AC/Hz
Average Power per Star Light	1.9	W
Dimming	Non-Dimmable	-
Power Factor	>0.5	-

Technical Specification

CL1S

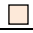
Optical Characteristics

Product Code	LED Colour		Colour Temp (K)	Bare LED Intensity (lm) *	Luminaire Intensity (lm) *	Angle (°)	Min CRI	Fitting Colour
CL1S		NW	4000	120	102	15,67	80	Wt,Al
CL1S		WW	3000	112	95	15,67	80	Wt,Al

NW = Natural White LED Colour

WW = Warm White LED Colour

* Values accurate to within 10%

Al = Aluminium

Wt = White

Wiring Diagram

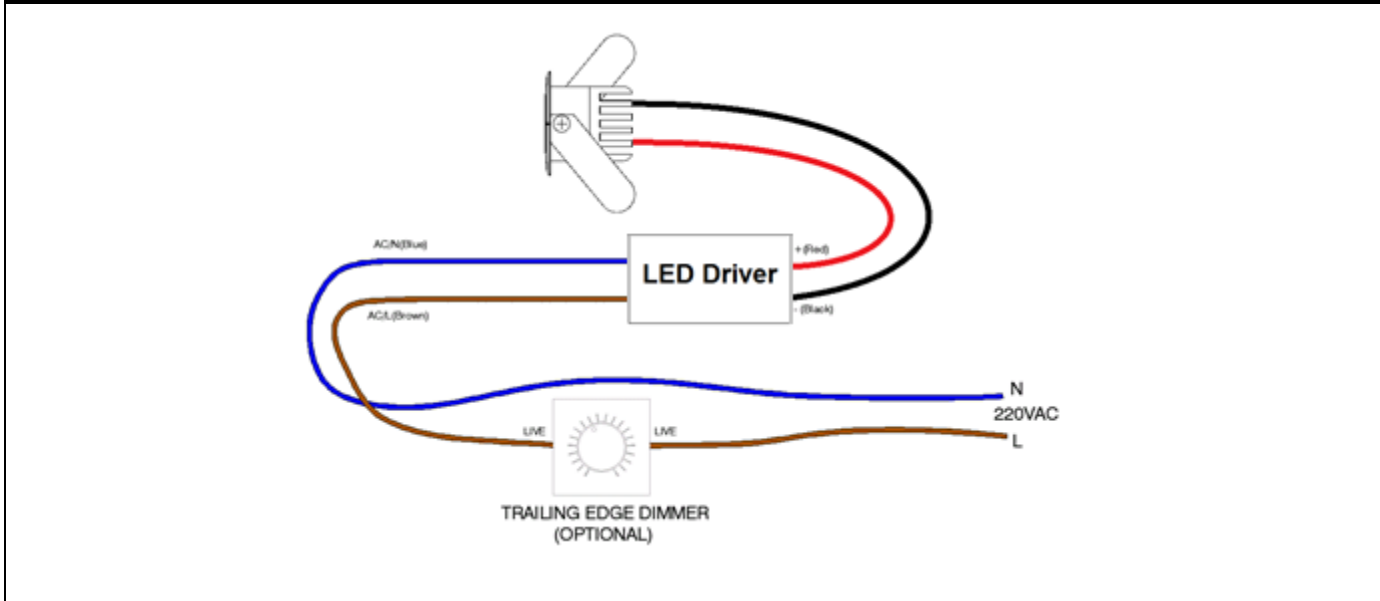

Polar Candela Distribution Diagram (NW 67°)

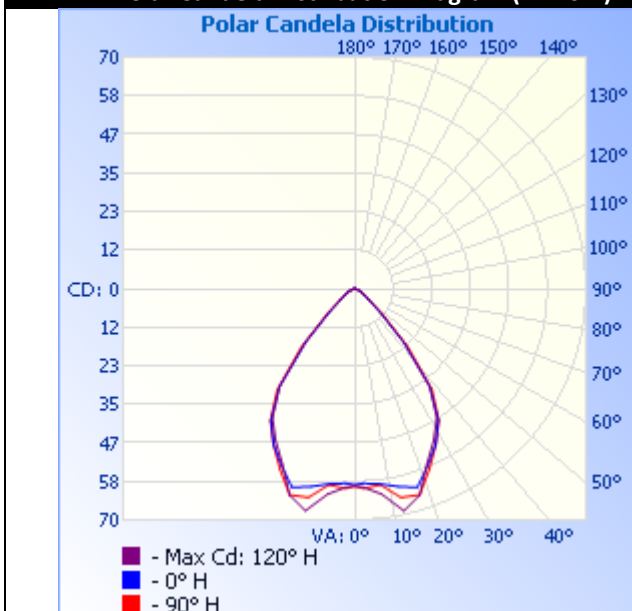

Illuminance at a Distance (NW 67°)

	Center Beam LUX	Beam Width	
0.5M	293.0 LUX	0.7 M	0.7 M
0.9M	73.2 LUX	1.4 M	1.4 M
1.4M	32.6 LUX	2.1 M	2.1 M
1.8M	18.3 LUX	2.8 M	2.9 M
2.3M	11.7 LUX	3.5 M	3.6 M
2.7M	8.1 LUX	4.1 M	4.3 M

■ Vert. Spread: 75.0°
■ Horiz. Spread: 76.8°

Technical Specification

CL1S

Product Ordering Code

Example: *CL1S-NW-67-AL-N*

<i>CL1S</i>	<i>NW</i>	<i>67</i>	<i>AL</i>	<i>N</i>
Product Code	Natural White LED Colour	Beam Angle	Fitting Colour	Non-Dimmable

Warning

DO NOT COVER WITH THERMAL INSULATION MATERIAL



Document Info

CL1S Rev 2